

# Future Facilities and Services - City of Neillsville

## Map 4-2

### Future Construction

#### Short Term

- New Sidewalk
- Reconstruct Road / Sewer / Water
- - - Road Upgrade
- Upgrade Intersection
- ⚠ Water Tower - Inspect & Paint

#### Long Term

- Construct Road
- New Sidewalk
- Reconstruct Road / Sewer / Water
- - - Road Upgrade
- ✈ Airport Upgrades
- ⚠ Construct New Public Park Restrooms
- Reconstruct Tennis Courts

#### Existing Facilities and Services

- Abandoned Landfills
- ⓧ Active Quarry
- ⚡ Cemetery
- ⛪ Church
- 🚗 City Garage
- 🏛 City Hall
- 🏢 Clark County Service Facilities
- 🚒 Fire Department
- 🏥 Health Care Facility
- 🚊 Lift Station
- 🏠 National Guard Armory
- 🚓 Police Station
- 📖 Public Library
- 🌳 Public Park
- ♻️ Recycle / Compost Facility
- 🎓 School - Private / Parochial
- 🎓 School - Public
- 🌧️ Storm Water Detention
- ⚡ Sub-Station
- 📮 U.S. Post Office
- 🏭 Wastewater Treatment Facility
- ⚙️ Water Dept. / Admin.
- ⚠ Water Tower
- 🏭 Water Treatment Facility
- ⬛ Well
- City Area Not Serviced by Public Sewer
- Developed Areas Serviced by Public Sewer

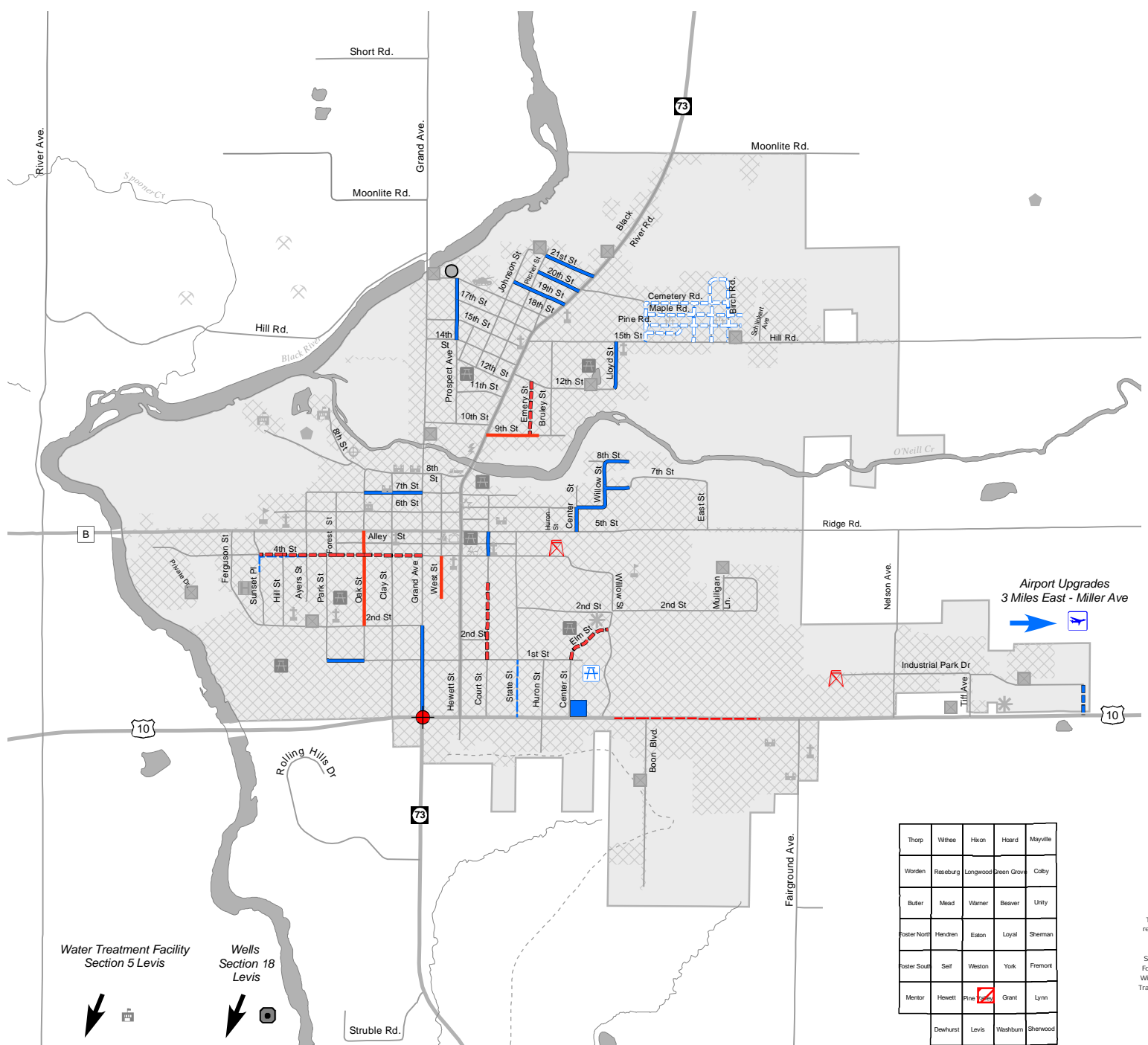

Thorp	Wheeler	Hixon	Hoard	Mayville
Worden	Reeseburg	Longwood	Green Grove	Coby
Butler	Mead	Warner	Beaver	Unity
Foster North	Hendren	Eaton	Loyal	Sherman
Foster South	Self	Weston	York	Fremont
Mentor	Hewitt	Pine Bluff	Grant	Lynn
Dewhurst	Levis	Washburn	Sherwood	

Water Treatment Facility  
Section 5 Levis

Wells  
Section 18  
Levis

This map is intended for advisory purposes only. It is based on sources believed to be reliable, but Clark County distributes this information on an 'AS IS' basis. No warranties are implied.

Source: Existing Facilities derived from Clark County Planning and Zoning, Clark County Forestry Department, Clark County Land Conservation, Clark County Health Department, Wisconsin Department of Natural Resources, and USGS 1:24,000 scale topographic maps. Trail locations may change periodically due to land agreements, landscape and trail design. Roads, Lakes, Rivers and Streams derived from 1997 aerial photographs.

All Data managed by a Geographical Information System (GIS) and provided by the Clark County Land Information Office, Courthouse Room 204, Neillsville, WI (715) 743-5130